

HOSPITAIR® G - 15 bar

Lubricated piston technology - 15 bar

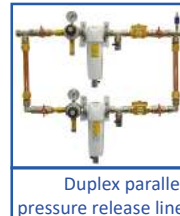

- Medicinal air plants with lubricated piston compressors
- Fit to EN ISO 7396-1 standard and HTM BS
- Modular components fitting any kind of technical room
- Air treatment system with adsorption air dryer SEC 7HC type
- Air quality complying with European pharmacopoeia
- Air receiver
- Simple or duplex parallel pressure release line
- CYCLIC 2020 or PROCOM 2 control device
- Integrated network alarm



Characteristics

HOSPITAIR® G 15 bar	Power kW 50 / 60 Hz	Flow rate * m ³ .h ⁻¹	Maxi Pressure bar	Noise level dB(A)		Oil filing L	Weight kg	
				Covered version	Standard version		Covered version	Standard version
12 K2	1,7	11	15	62	71	1,1	100	45
20 K2	3	20	15	67	75	1,2	160	70
27 K2	4	27	15	68	77	1,2	170	95
37 K2	5,5	37	15	70	79	1,5	265	125
50 K2	7,5	49	15	72	80	1,5	270	130

* Compressor flow rate

Process sequence (ex : duplex plant)

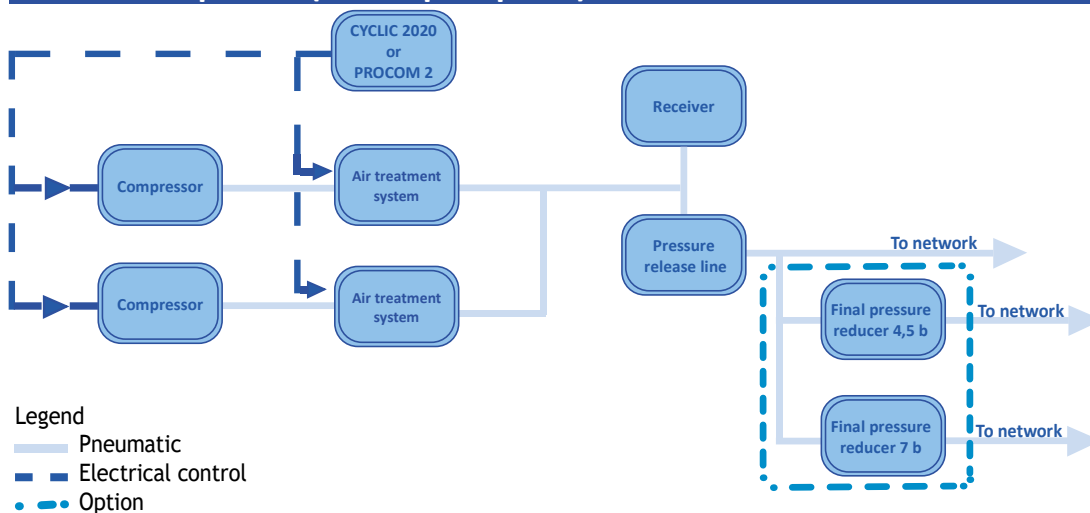

Range complying with 93/42/CEE directive



Range complying with 97/23/CE directive

Available set-up

	1 production assembly	2/3 production assemblies
PROCOM 2	○	■
CYCLIC 2020	■	■
Single pressure release line	■	◆
Duplex parallel pressure release line	◆	■
Hygrometer	■	■
Network alarm	■	■
Sound proofing box	◆	◆
CO monitoring	◆	◆

Power supply

- 3-phase, 400V+N+E / 50Hz

- Standard equipment
- ◆ Optional equipment
- Not available

Medicinal air plants

Lubricated piston compressor



Dimensions (mm)

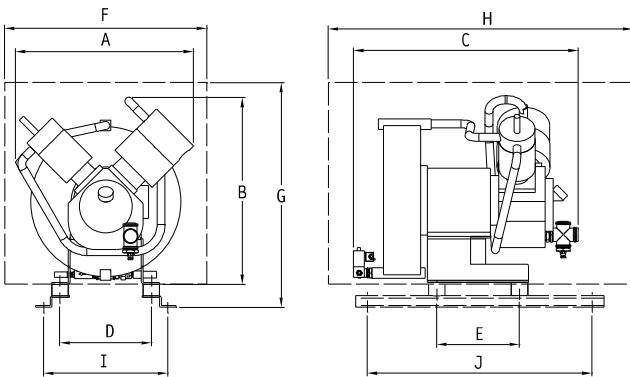

Control boards, see page 80

Air treatment devices, see page 70

Pressure release lines, see page 74

Air receivers, see page 79

HOSPITAIR® G 15 bar	Standard version				
	A	B	C	D	E
12 K2	440	430	510	260	465
20 K2	570	590	620	275	250
27 K2	600	610	630	275	250
37 K2	670	630	800	350	320
50 K2	720	650	800	350	320

HOSPITAIR® G 15 bar	Covered version				
	F	G	H	I	J
12 K2	470	620	780	375	700
20 K2	610	740	930	380	700
27 K2	610	720	920	375	700
37 K2	730	800	1080	446	913
50 K2	730	800	1080	446	913

Plant references

HOSPITAIR® G - 15 bar		12 K2	20 K2	27 K2	37 K2	50 K2
Compressor base frame, exhaust hose, unloading system 3-phase, 400V+N+E / 50Hz	Covered version	X x 922039	X x 921886	X x 921888	X x 921890	X x 921892
	Standard version	X x 922038	X x 921885	X x 921887	X x 921889	X x 921891
CYCLIC 2020 control device (dew point sensor included)	1 line	822040	822043	815664	815665	815666
	2 lines	822041	822044	814462	814463	814464
	3 lines	822042	822045	814467	814468	814469
PROCOM 2 control device (dew point sensor included)	2 lines	722046	722048	716877	716878	716879
	3 lines	722047	722049	716881	716882	716883
SEC 7HC DUPLEX Air treatment system		CY10 - PF36 - SUB36 AD5035 / CHA36 X x 924124				CY20-PF & SUB72 AD5065/CHA72 X x 924125
	for 1 line		DP36S 724001			DP72S 723946
PRESSURE RELEASE LINE Wall fixation	for 2 lines		DP72DP 724004			
	for 3 lines		DP72DP 724004			DP144DP 724005
AIR RECEIVER 15 bar		1 x 500 liters 721126			1 x 1000 liters 721127	

Accessories and option references

Report Status with CYCLIC 2020 *	12 first alarms	614079	12 following alarms	622463
Report Status with PROCOM 2 *	12 first alarms	624265	12 following alarms	624266
CO monitoring	CYCLIC 2020	724915	PROCOM 2	724912
Oil-water separator	Owamat 10 < 84m³/h	359423	Owamat 11 < 168m³/h	362859
Oil level security	One per compressor	622827		
Transformer for assembly without neutral	One per compressor	616038		

* Do not forget to order electrical cord 615892 x 3 (see p 83)

Specifications are subject to be changed without notice

HOSPITAIR® G - 11 bar

Lubricated screw technology



Modular system

- Medicinal air plants with lubricated screw compressors
- Fit to EN ISO 7396-1 standard and HTM BS
- Adsorption air dryer
- Air quality complying with European pharmacopoeia
- Built-in hygrometry sensor
- Air receiver(s) and final filtration
- Several regulation modes proposed (see available set-up)
- Easy installation with quick connectors



Characteristics

HOSPITAIR® G 11 bar	Power kW 50/ 60 Hz	Flow rate * m ³ .h ⁻¹		Air dryer type	Noise level dB(A) **	Weight kg	Compressor dimension L x D x H / mm
		at 50 Hz	at 60 Hz				
MVX4	4	29	29	AD5035	62	145	590 x 632 x 970
MVX5	5,5	40	40	AD5065	64	155	590 x 632 x 970
MVA9	7,5	65	65	AD5065	65	240	630 x 790 x 1100
MVB12	11	100	100	AD5130	64	312	750 x 895 x 1260
MVB16	15	126	130	AD5130	65	320	750 x 895 x 1260
MVC19	18,5	179	174	AD5195	67	505	800 x 1100 x 1530
MVC23	22	210	207	AD5260	69	525	800 x 1100 x 1530
MVD31	30	269	274	AD5325	69	750	1460 x 960 x 1530
MVE38	37	336	326	AD5325	70	985	1590 x 1030 x 1700
MVE46	45	411	395	AD5455	71	1060	1590 x 1030 x 1700

* Compressor flow rate further to ISO 1217 : 1996 - C Annex

** Noise level further to PN8 NTC 2.3, measured one meter away in free area

Process sequence (ex : duplex plant)

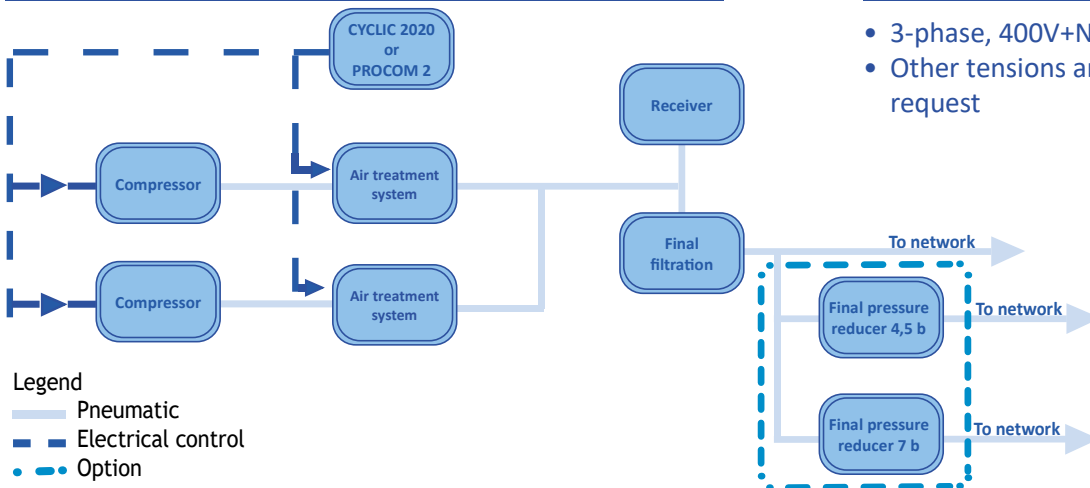

Power supply

- 3-phase, 400V+N+E / 50Hz (standard)
- Other tensions and frequencies on request



Range complying with 93/42/CEE directive



Range complying with 97/23/CE directive

Available set-up

	1 production assembly	2 or 3 production assemblies	4 production assemblies & more
PROCOM 2	■	■	■
CYCLIC 2020	■	■	○
Simple final filtration	■	◆	◆
Duplex parallel final filtration	◆	■	■
Hygrometer	■	■	■
Network alarm	■	■	■
Oil-water separator	◆	◆	◆
CO monitoring	◆	◆	◆

- Standard equipment
- ◆ Optional equipment
- Not available equipment

Medicinal air plants

Lubricated screw compressor



Duplex parallel final filtration



Control board CYCLIC 2020



SEC 7HC air treatment device



Quick connector

EASY INSTALLATION

Quick connector from electrical board to compressor and to dryer.

Delivered with 10m of cable

Plant references

HOSPITAIR® G - 11 b 3-ph 400V / 50 Hz	MVX4	MVX5	MVA9	MVB12	MVB16	MVC19	MVC23	MVD31	MVE38	MVE46
Screw compressor + exhaust hose + check valve + control kit	X x 820993	X x 820994	X x 824398	X x 820996	X x 820997	X x 820998	X x 823943	X x 823944	X x 823945	X x 823946
HOSPITAIR® G - 11 b 3-ph 380V / 60 Hz	MVX4	MVX5	MVA9	MVB12	MVB16	MVC19	MVC23	MVD31	MVE38	MVE46
Screw compressor + exhaust hose + check valve + control kit	X x 824036	X x 824037	X x 824402	X x 824039	X x 824040	X x 824041	X x 824042	X x 824043	X x 824044	X x 824045
CYCLIC 2020 control device	1 comp. : 823961			2 comp. : 823962			3 comp. : 823963			
PROCOM 2 control device	1 comp. : 823964			2 comp. : 823965			3 comp. : 823966		4 comp. : 823967	
SEC 7HC Air treatment unit	AD5035 X x 923903	AD5065 X x 923905	AD5130 X x 923954	AD5195 X x 923957	AD5260 X x 923981	AD5325 X x 924368	AD5455 X x 924369			
FINAL FILTRATION wall fixation	1 line	FP36S 724009	FP72S 724010	FP109S 724011	FP217S 724012	FP396S 724013				
	2 lines	FP72DP 724014	FP144DP 724015	FP218DP 724016	FP434DP 724017					
	3 lines	FP72DP 724014	FP144DP 724015	FP218DP 724016	FP434DP 724017	FP792DP 724018				
VERTICAL AIR RECEIVER with equipment - 11 bar <i>see page 81</i>	1 x 900 l 1 x 721119		2 x 1000 l 2 x 724999		3 x 1500 l 3 x 721121		3 x 2000 l 3 x 721122			

Accessories and option references

Report Status with CYCLIC 2020 *	12 first alarms	614079	12 following alarms	622463
Report Status with PROCOM 2 *	12 first alarms	624265	12 following alarms	624266
Duplex pressure release line	DD BP300 - 4,5 bar	622305	DD BP300 - 7 bar	622306
	DD BP500 - 4,5 bar	624813	DD BP500 - 7 bar	624814
CO monitoring	CYCLIC 2020	724915	PROCOM 2	724912
Oil-water separator	See page 63			

* Do not forget to order electrical cord 615892 x 3 (see p 83)

Specifications are subject to be changed without notice

HOSPITAIR® G - 15 bar

Lubricated screw technology



Modular system

- Medicinal air plants with lubricated screw compressors
- Fit to EN ISO 7396-1 standard and HTM BS
- Adsorption air dryer
- Air quality complying with European pharmacopoeia
- Built-in hygrometry sensor
- Air receiver(s) and pressure release line
- Several regulation modes proposed (see available set-up)
- Easy installation with quick connectors



Characteristics

HOSPITAIR® G 15 bar	Power kW 50/ 60 Hz	Flow rate * m ³ .h ⁻¹		Air dryer type	Noise level dB(A) **	Weight kg	Dimension compressor L x D x H / mm
		at 50 Hz	at 60 Hz				
MVX4	4	22	22	AD5035	62	145	590 x 632 x 970
MVX5	5,5	32	32	AD5035	64	155	590 x 632 x 970
MVA9	7,5	50	50	AD5065	65	240	630 x 790 x 1100
MVB12	11	78	78	AD5065	64	312	750 x 895 x 1260
MVB16	15	102	106	AD5130	65	320	750 x 895 x 1260
MVC19	18,5	150	144	AD5195	67	505	800 x 1100 x 1530
MVC23	22	174	170	AD5195	69	525	800 x 1100 x 1530
MVD31	30	223	214	AD5260	69	750	1460 x 960 x 1530
MVE38	37	266	271	AD5325	70	985	1590 x 1030 x 1700
MVE46	45	328	320	AD5325	71	1060	1590 x 1030 x 1700

* Compressor flow rate further to ISO 1217 : 1996 - C Annex

** Noise level further to PN8 NTC 2.3, measured one meter away in free area

Process sequence (ex : duplex plant)

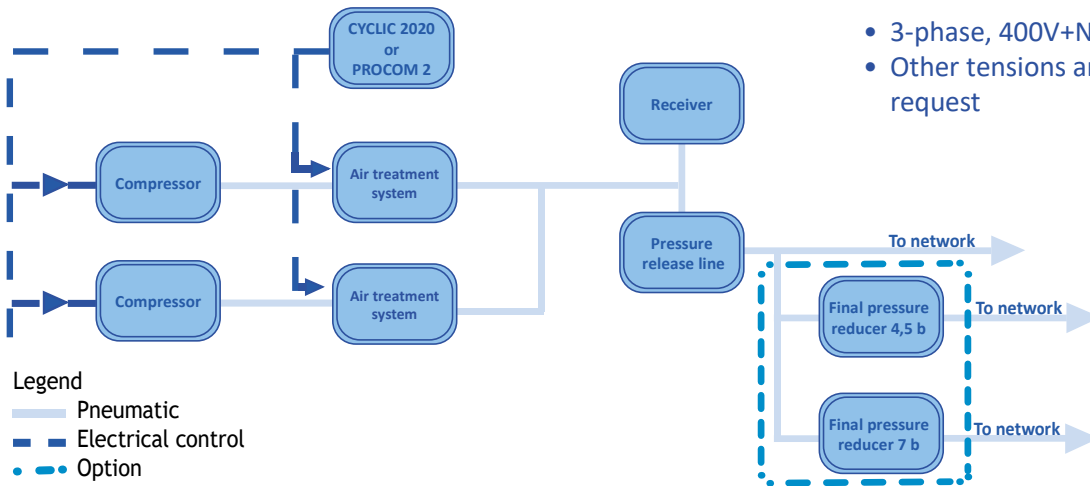

Legend

- Pneumatic
- - - Electrical control
- Option

Power supply

- 3-phase, 400V+N+E / 50Hz (standard)
- Other tensions and frequencies on request

Available set-up

	1 production assembly	2 or 3 production assemblies	4 production assemblies & more
PROCOM 2	■	■	■
CYCLIC 2020	■	■	○
Single pressure release line	■	◆	◆
Duplex parallel pressure release line	◆	■	■
Hygrometer	■	■	■
Network alarm	■	■	■
Oil-water separator	◆	◆	◆
CO monitoring	◆	◆	◆

- Standard equipment
- ◆ Optional equipment
- Not available equipment



Range complying with 93/42/CEE directive



Range complying with 97/23/CE directive

Medicinal air plants

Lubricated screw compressor



Duplex parallel pressure release line



Control board CYCLIC 2020



SEC 7HC air treatment device



Quick connector

EASY INSTALLATION

Quick connector from electrical board to compressor and to dryer.

Delivered with 10m of cable

Plant references

HOSPITAIR® G - 15 b	MVX4	MVX5	MVA9	MVB12	MVB16	MVC19	MVC23	MVD31	MVE38	MVE46
Screw compressor + exhaust hose + check valve + control kit	X x 821455	X x 821468	X x 824397	X x 823512	X x 823513	X x 823980	X x 823939	X x 823940	X x 823941	X x 823942
CYCLIC 2020 control device	1 comp. : 823961		2 comp. : 823962			3 comp. : 823963				
PROCOM 2 control device	1 comp. : 823964		2 comp. : 823965		3 comp. : 823966		4 comp. : 823967			
SEC 7HC Air treatment unit	AD5035 X x 923903	AD5065 X x 923905	AD5130 X x 923954	AD5195 X x 923957	AD5260 X x 924367	AD5325 X x 924368				
	1 line DP36S 724001	DP72S 723946	DP109S 724002	DP217S 723947	DP396S 724003					
PRESSURE RELEASE LINE wall fixation	2 lines DP72DP 724004	DP144DP 724005	DP218DP 724006	DP434DP 724007	DP792DP 724008					
	3 lines DP72DP 724004	DP144DP 724005	DP218DP 724006	DP434DP 724007	DP792DP 724008					
VERTICAL AIR RECEIVER with equipment - 15 bar <i>see page 81</i>	1 or 2 lines 1 x 500 l 1 x 721126	1 x 1000 l 1 x 721127	1 x 1500 l 1 x 721128	2 x 1000 l 2 x 721127	2 x 1500 l 2 x 721128					
	3 lines 1 x 1000 l 1 x 721127	1 x 1500 l 1 x 721128	2 x 1000 l 1 x 721127	2 x 1500 l 2 x 721128						

Accessories and option references

Report Status with CYCLIC 2020 *	12 first alarms	614079	12 following alarms	622463
Report Status with PROCOM 2 *	12 first alarms	624265	12 following alarms	624266
Duplex pressure release line	DD BP300 - 4,5 bar	622305	DD BP300 - 7 bar	622306
	DD BP500 - 4,5 bar	624813	DD BP500 - 7 bar	624814
CO monitoring	CYCLIC 2020	724915	PROCOM 2	724912
Oil-water separator	See page 63			

* Do not forget to order electrical cord 615892 x 3 (see p 83)

Specifications are subject to be changed without notice